

PLAN OF SUBDIVISION



PDA Surveyors

Surveying, Engineering & Planning

3/23 Brisbane Street, Launceston
Tasmania 7250
www.pda.com.au
Also at: Burnie, Devonport & Hobart
ABN 71 217 806 325
PHONE: +61 03 6331 4099
FAX: +61 03 6334 3098
EMAIL: pda.tn@pda.com.au

Owners	Judith Ann Fellows and Richie James Fellows	Address	85 Dexter Street, Westbury Tas 7303	This plan has been prepared only for the purpose of obtaining preliminary subdivision approval from the Council and the information shown hereon should be used for no other purpose. All measurements and areas are subject to final survey.
		Council	Meander Valley Council	
		Planning Scheme	Meander Valley Interim Planning Scheme 2013	
		Zone & Overlay	12.0 Low Density Residential	
Title References	FR 128445/1			
Schedule Of Easements	As shown.			
Scale	1:1000	Date	16 January 2017	PDA Reference
				L16218-1
		Map reference	4840	PID
				2790464
		Point of Interest	GDA94 MGA55	487 018 E, 5 402 088 N

STAGING
Stage 1 - Lot 1
Stage 2 - Lots 2 & 3

Meander Valley Council
This is the plan referred to in the attached
Permit No: PA\17\0135
Approval subject to the conditions of the attached
Permit
[Signature]
TOWN PLANNER
Pages 1 to 27 inclusive
Date 24 April 2017
THIS IS NOT A BUILDING PERMIT



PLAN OF SUBDIVISION



PDA Surveyors

Surveying, Engineering & Planning

3/23 Brisbane Street Launceston,
Tasmania, 7000
www.pda.com.au
Also at: Burnie, Devonport & Hobart
ABN 71 217 806 325

PHONE: +61 03 6331 4099
FAX: +61 03 6331 3098
EMAIL: pda.ltr@pda.com.au

Owners	Stephen Barry Walker & Bronwyn Kay Hingston		Address	69 King Street Westbury		This plan has been prepared only for the purpose of obtaining preliminary subdivision approval from the Council and the information shown hereon should be used for no other purpose. All measurements and areas are subject to final survey.					
			Council	Meander Valley Council							
			Planning Scheme	Meander Valley Interim Planning Scheme 2013							
Title References	FR 240103/1		Zone & Overlay	12.0 Low Density Residential							
Schedule Of Easements			Nil.								
Scale	1:500	Date	22 May 2017	PDA Reference	L17072-1	Map reference	4840-42	PID	1545854	Point of Interest GDA94 MGA55	487265E, 5402497N

LEGEND

- Title/Proposed boundary
- - - Other boundary
- - - Sewer line
- w - Water line



PLAN OF SUBDIVISION



PDA Surveyors

Surveying, Engineering & Planning

3/23 Brisbane Street, Launceston
Tasmania, 7250
www.pda.com.au
Also at: Burnie, Devonport & Hobart
ABN 71 217 806 325
PHONE +61 03 6331 4099
FAX +61 03 6334 3098
EMAIL pda.tin@pda.com.au

Owners	PREMIUM CUSTODY SERVICES PTY LTD	Address	30 Pensioners Row, Westbury Tas 7303			This plan has been prepared only for the purpose of obtaining preliminary subdivision approval from the Council and the information shown hereon should be used for no other purpose. All measurements and areas are subject to final survey.						
		Council	Meander Valley Council									
		Planning Scheme	Meander Valley Interim Planning Scheme 2013									
Title References	FR 16611/1	Zone & Overlay	12.0 Low Density Residential									
Schedule Of Easements		As shown.										
Scale	1:800	Date	15 February 2017	PDA Reference	L16219-1	Map reference	4840	PID	7015731	Point of Interest	GDA94 MGA55	487051E, 5402265N

Meander Valley Council
This is the plan referred to in the attached
Permit No: PA\17\0130
Approval subject to the conditions of the attached
Permit
Whiteley
TOWN PLANNER
Pages 1 to 25 inclusive
THIS IS NOT A BUILDING PERMIT
24 April 2017
Date

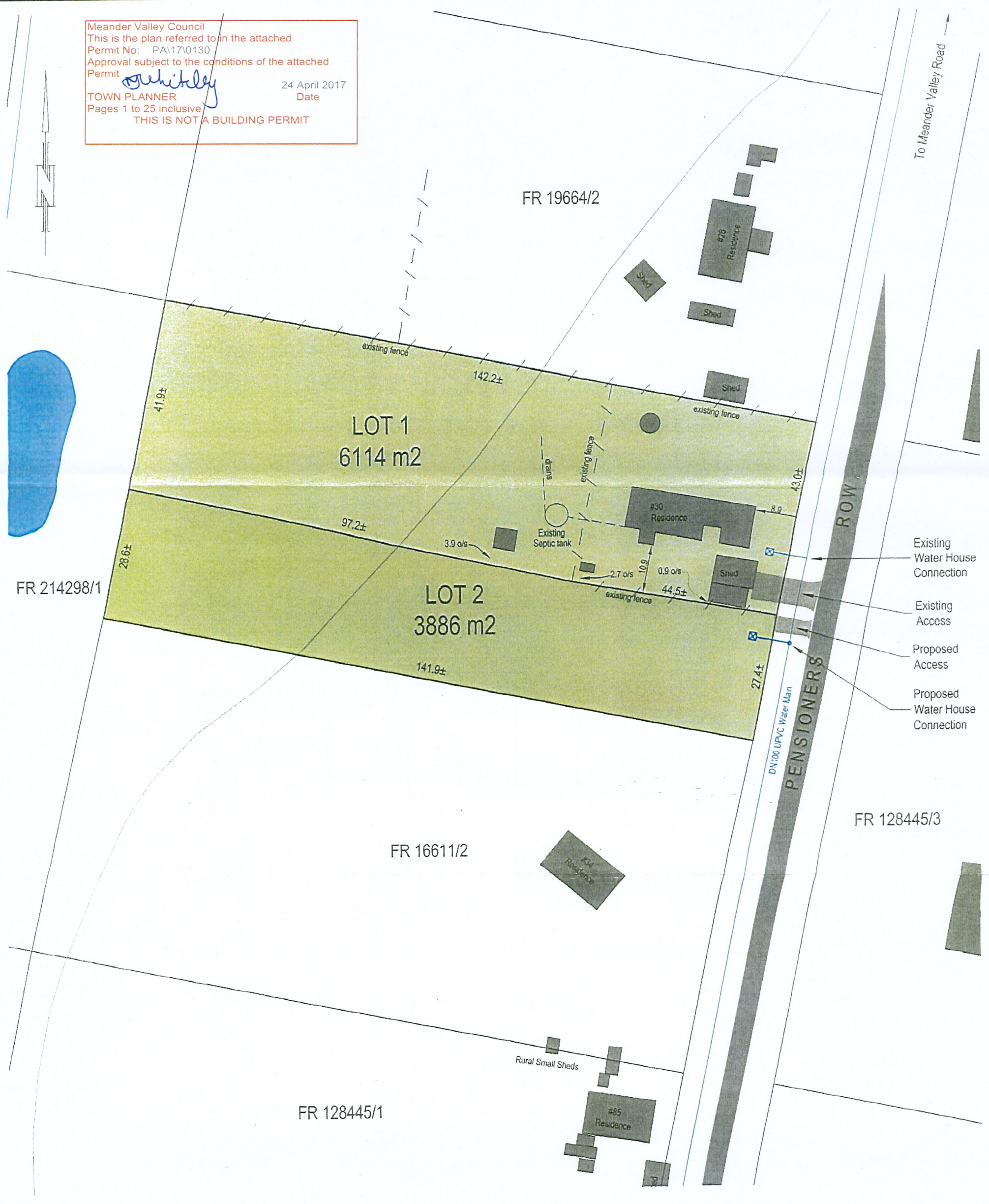

2

PLAN OF SUBDIVISION



PDA Surveyors

Surveying, Engineering & Planning

3/23 Brisbane Street,
Launceston, Tasmania, 7250
www.pda.com.au Also at: Hobart,
Burnie, Devonport
& Kingston
ABN 71 217 806 325
PHONE: +61 03 6331 4099
FAX: +61 03 6334 3098
EMAIL: pda.ltn@pda.com.au

Owners	Judith Ann Fellows	Address	64 Ritchie Street, Westbury			This plan has been prepared only for the purpose of obtaining preliminary subdivision approval from the Council and the information shown hereon should be used for no other purpose. All measurements and areas are subject to final survey.					
		Council	Meander Valley Council								
		Planning Scheme	Meander Valley Interim Planning Scheme 2013								
Title References	FR 121737/1	Zone & Overlay	12.0 Low Density Residential								
		Schedule Of Easements NIL.									
Scale	1 : 1000	Date	20 February 2017	PDA Reference	L17016-1	Map reference	4840-52	PID	7015985	Point of Interest GDA94 MGA55	487590E, 5401800N

STAGING:

- STAGE 1 LOT 1
- STAGE 2 LOT 2 & LOT 3

