

# TASMANIAN PLANNING SCHEME - LAUNCESTON

Rezoning 9 Rose Lane, South Launceston (described as CT247578/2 and CT200709/1)  
from Recreation Zone to General Residential Zone.

Amend the Tasmanian planning scheme maps as below:

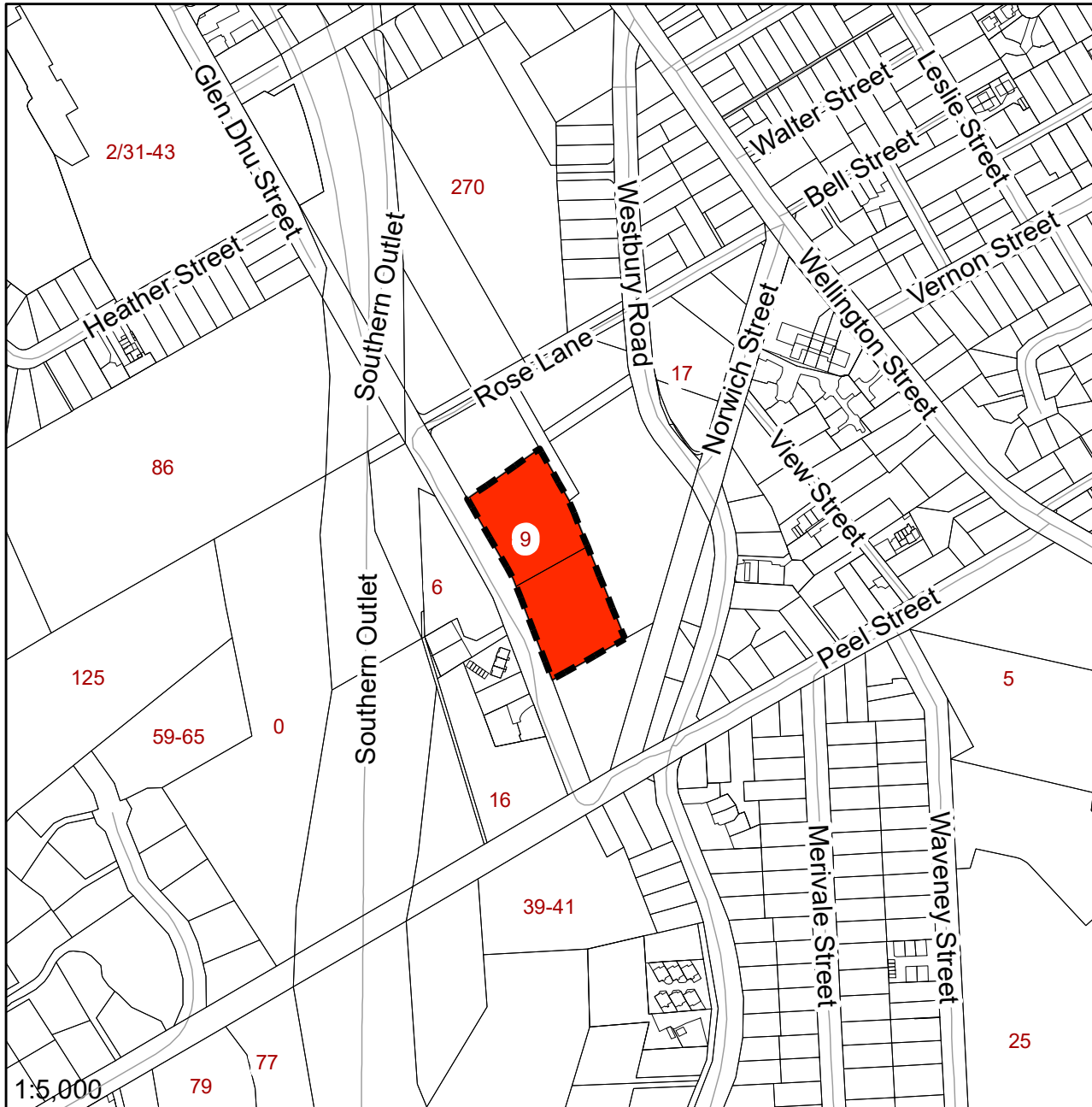

Zoning



General Residential Zone

THE COMMON SEAL  
of the City of  
Launceston was  
hereunto affixed in the  
presences of: -

Michael Stretton  
Chief Executive Officer

Date