

Carolyn Rimmer

From: Debra Bellchambers
Sent: Tuesday, 23 May 2023 3:17 PM
To: Debra Bellchambers
Subject: FW: Please explain

Debra Bellchambers

DEVELOPMENT AND REGULATORY SERVICES SUPPORT OFFICER



Latrobe Council

170 Gilbert Street
 PO Box 63 Latrobe 7307

(03) 6426 4444

www.latrobe.tas.gov.au



www.facebook.com/latrobecounciltas



Kentish Council

69 High Street
 PO Box 63 Sheffield 7306

(03) 6491 0200

www.kentish.tas.gov.au



www.facebook.com/kentishcouncil

Disclaimer: This email and any files transmitted with it are confidential and intended solely for the use of the individual or entity to which it is addressed and contains information that is privileged and confidential. If you are not the named addressee you should not disseminate, distribute, copy or alter this email. Any views or opinions presented in this email are solely those of the author and might not represent those of the Council. Warning: Although the Council has taken reasonable precautions to ensure no viruses are present in this email, it cannot accept responsibility for any loss or damage arising from the use of this email or attachments.

Do you need to print this? [Rethink waste. Visit www.rethinkwaste.com.au](http://www.rethinkwaste.com.au)

From: Shelly Laundry <racingscort1970@gmail.com>
Sent: Saturday, May 20, 2023 3:46 PM
To: Kentish Council <council@kentish.tas.gov.au>
Subject: Please explain

You don't often get email from racingscort1970@gmail.com. [Learn why this is important](#)

To whom it may concern,

Have been trying to make sense of the particular information in regards to my property.

What is actually going on and what is it you are trying to do?

Attached is the article I'm trying to work out. The green spots on the map.

Regards
 Owner of property
 Michelle Maxfield



Threatened Fauna and S

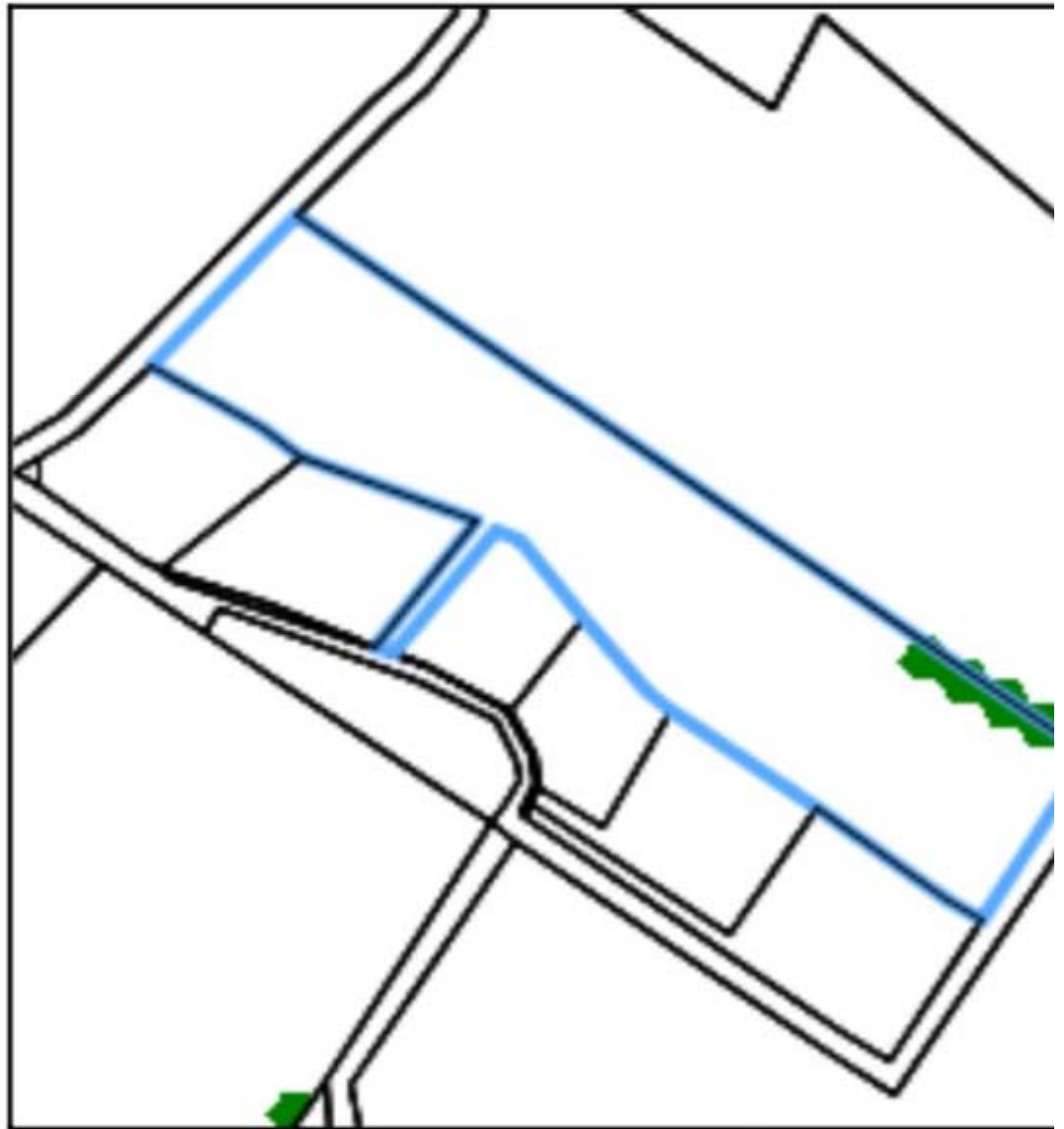

Threatened Fauna Habitat
• spotted-tailed quoll

--

Sent from Shelly

Carolyn Rimmer

From: Latrobe Planning
Sent: Wednesday, 2 August 2023 1:53 PM
To: Carolyn Rimmer
Subject: FW: Planning enquiry - power lines proposed near 655 Staverton Rd - 0407 512 861

Follow Up Flag: Follow up
Flag Status: Flagged

Debra Bellchambers

DEVELOPMENT AND REGULATORY SERVICES SUPPORT OFFICER



Latrobe Council

170 Gilbert Street
PO Box 63 Latrobe 7307

(03) 6426 4444

www.latrobe.tas.gov.au



www.facebook.com/latrobecounciltas

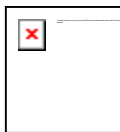

Kentish Council

69 High Street
PO Box 63 Sheffield 7306

(03) 6491 0200

www.kentish.tas.gov.au



www.facebook.com/kentishcouncil

Disclaimer: This email and any files transmitted with it are confidential and intended solely for the use of the individual or entity to which it is addressed and contains information that is privileged and confidential. If you are not the named addressee you should not disseminate, distribute, copy or alter this email. Any views or opinions presented in this email are solely those of the author and might not represent those of the Council. Warning: Although the Council has taken reasonable precautions to ensure no viruses are present in this email, it cannot accept responsibility for any loss or damage arising from the use of this email or attachments.

Do you need to print this? *Rethink waste.* Visit www.rethinkwaste.com.au

From: Judy Kilby <judy.kilby@latrobe.tas.gov.au>
Sent: Thursday, May 25, 2023 10:50 AM
To: Planning <planning@latrobe.tas.gov.au>; racingescort1970@gmail.com
Subject: RE: Planning enquiry - power lines proposed near 655 Staverton Rd - 0407 512 861

Hi Andrew,

Michelle asked if you can please give her a call re the zoning.

Thanks

Jude Kilby
CUSTOMER SERVICE OFFICER



Latrobe Council

170 Gilbert Street
PO Box 63 Latrobe 7307

(03) 6426 4444

www.latrobe.tas.gov.au



www.facebook.com/latrobecounciltas



Kentish Council

69 High Street
PO Box 63 Sheffield 7306

(03) 6491 0200

www.kentish.tas.gov.au



www.facebook.com/kentishcouncil

Disclaimer: This email and any files transmitted with it are confidential and intended solely for the use of the individual or entity to which it is addressed and contains information that is privileged and confidential. If you are not the named addressee you should not disseminate, distribute, copy or alter this email. Any views or opinions presented in this email are solely those of the author and might not represent those of the Council. Warning: Although the Council has taken reasonable precautions to ensure no viruses are present in this email, it cannot accept responsibility for any loss or damage arising from the use of this email or attachments.

Do you need to print this? *Rethink waste.* Visit www.rethinkwaste.com.au

From: Planning <planning@latrobe.tas.gov.au>

Sent: Wednesday, May 24, 2023 12:40 PM

To: racingescort1970@gmail.com

Subject: RE: Planning enquiry - power lines proposed near 655 Staverton Rd

Hello Michelle,

Thank you for your enquiry in relation to transmission line upgrades adjacent to 655 Staverton Road in Staverton. TasNetworks are upgrading a number of transmission corridors to provide increased capacity to support new and existing renewable energy developments in the region. Some works may not require a development application for planning approval through Council.

If you have specific enquiries regarding TasNetwork's North West Transmission Developments project, you are best advised to contact TasNetworks directly to understand how the proposed works may affect you. More information is available on their website:

<https://www.tasnetworks.com.au/Poles-and-wires/Planning-and-developments/North-West-Transmission-Developments>

In relation to the Tasmanian Planning Scheme and the Kentish Local Provisions, I can confirm that your property is proposed to be rezoned from the current Rural Resource zoning to **Rural**. The process in changing to the new Planning Scheme is a transitional process where we are required to apply the most applicable zoning from the Tasmanian Planning Scheme zone template. The Rural Resource zone is the predominate rural zoning that applies to land parcels outside of the town centres, applying to agricultural, grazing, forestry and mining areas. The new Planning Scheme replaces Rural Resource with either an Agriculture or Rural zoning, depending on a number of factors such as predominate land uses, land size, topography, and land soil capability and rating. More information is available on the Council's website

Should you wish to discuss the Planning Scheme changes more specifically, it would be best to make an appointment as there are a large number of variables and hypotheticals depending on the queries to be asked and whether you may wish to undertake any development in the future. Please do not hesitate to reply to this email to arrange an

appointment time; I am available at Kentish office by appointment Wednesday-Thursday and Latrobe office Monday-Tuesday.

If you have any further questions or queries, please do not hesitate to contact us.
Yours sincerely,

Andrew Newton
STATUTORY PLANNING OFFICER



Latrobe Council

170 Gilbert Street
PO Box 63 Latrobe 7307

(03) 6426 4444

www.latrobe.tas.gov.au



www.facebook.com/latrobecounciltas

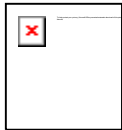

Kentish Council

69 High Street
PO Box 63 Sheffield 7306

(03) 6491 0200

www.kentish.tas.gov.au



www.facebook.com/kentishcouncil

Disclaimer: This email and any files transmitted with it are confidential and intended solely for the use of the individual or entity to which it is addressed and contains information that is privileged and confidential. If you are not the named addressee you should not disseminate, distribute, copy or alter this email. Any views or opinions presented in this email are solely those of the author and might not represent those of the Council. Warning: Although the Council has taken reasonable precautions to ensure no viruses are present in this email, it cannot accept responsibility for any loss or damage arising from the use of this email or attachments.

Do you need to print this? *Rethink waste.* Visit www.rethinkwaste.com.au

From: Judy Kilby <judy.kilby@latrobe.tas.gov.au>

Sent: Wednesday, May 24, 2023 12:16 PM

To: Planning <planning@latrobe.tas.gov.au>

Cc: racingescort1970@gmail.com

Subject: Pls contact Michelle Maxfield re power lines proposed near her property at 655 Staverton Rd Staverton (new planning scheme) 0407 512 861

Good afternoon team,

Can someone please contact Michelle to discuss proposed power lines.

Thanks

Jude Kilby
CUSTOMER SERVICE OFFICER



Latrobe Council



Kentish Council

170 Gilbert Street
PO Box 63 Latrobe 7307

(03) 6426 4444

69 High Street
PO Box 63 Sheffield 7306

(03) 6491 0200

www.latrobe.tas.gov.au



www.facebook.com/latrobecounciltas

www.kentish.tas.gov.au



www.facebook.com/kentishcouncil

Disclaimer: This email and any files transmitted with it are confidential and intended solely for the use of the individual or entity to which it is addressed and contains information that is privileged and confidential. If you are not the named addressee you should not disseminate, distribute, copy or alter this email. Any views or opinions presented in this email are solely those of the author and might not represent those of the Council. Warning: Although the Council has taken reasonable precautions to ensure no viruses are present in this email, it cannot accept responsibility for any loss or damage arising from the use of this email or attachments.

Do you need to print this? *Rethink waste.* Visit www.rethinkwaste.com.au